

REINFORCED CONCRETE WITH TRITON TT ADMIX W.T.C

PLATON DOUBLE DRAIN MEMBRANE

2-3 COATS TRITON TT VAPOUR MEMBRANE OR TT EX100

TRITON TT WATERSTOP/SWELLMASTIC

TRITON TT FILLET SEAL

REINFORCED CONCRETE WITH TRITON TT ADMIX W.T.C

GEOTEXTILE

SINGLE SIZE AGGREGATE

LAND DRAIN TO SUITABLE DISCHARGE POINT

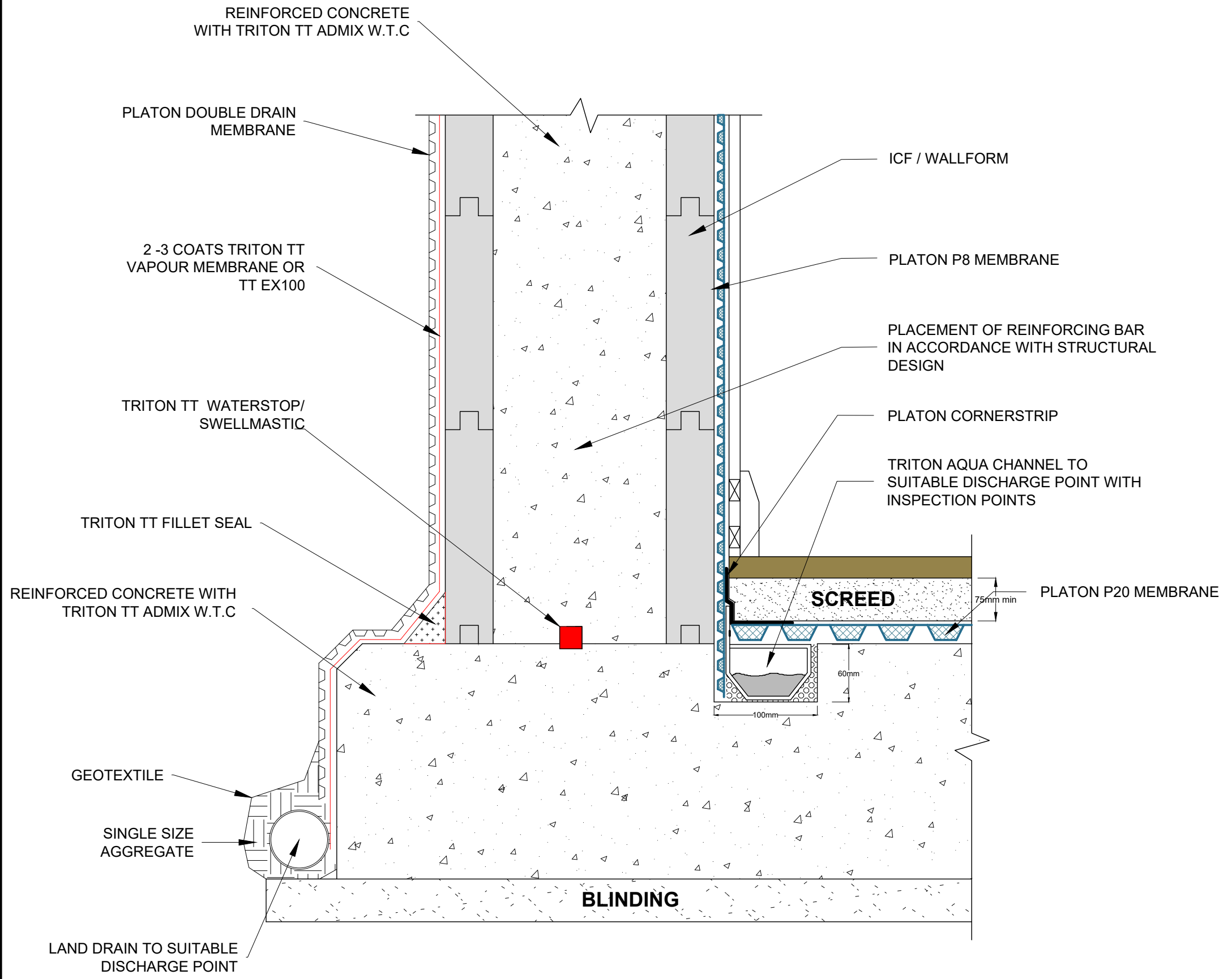

ICF / WALLFORM

PLATON P8 MEMBRANE

PLACEMENT OF REINFORCING BAR IN ACCORDANCE WITH STRUCTURAL DESIGN

PLATON CORNERSTRIP

TRITON AQUA CHANNEL TO SUITABLE DISCHARGE POINT WITH INSPECTION POINTS

SCREED

PLATON P20 MEMBRANE

BLINDING



www.tritonsystems.co.uk

Triton Systems

Units 3 - 5 Crayford Commercial Centre
Greyhound Way, Crayford, Kent. DA1 4HF

Telephone: **01322 318830**

Fax: **01322 524017**

Email: **info@tritonsystems.co.uk**

Web: **www.tritonsystems.co.uk**

THIS DRAWING IS THE PROPERTY OF TRITON SYSTEMS AND MUST NOT BE LOANED OR COPIED WITHOUT PRIOR WRITTEN CONSENT

© 2018 TRITON SYSTEMS

NOTE

ALL INSTALLATION TO BE CARRIED OUT IN STRICT ACCORDANCE WITH MANUFACTURERS INSTALLATION INSTRUCTIONS. FOR FURTHER ASSISTANCE CONTACT TRITON TECHNICAL ON THE TELEPHONE NUMBER ABOVE.

REV.	MOD. BY	DATE	CHK. BY	APP. BY
Alterations				

TITLE:
ICF / WALLFORM
Waterproofing Options:
Grade 3 - High Risk
TRITON - PLATON COMBINED
WATERPROOFING SYSTEMS

DRG. No.	TWS-072-2(D)	REV	3
-----------------	---------------------	------------	----------

DRAWN	KD/JDF, AJ	System Files: TWS-072-1(D).pdf TWS-072-1(D).dwg
DATE	11th June 2018	
SCALE (A3)	Not To Scale	
CHECKED		
APPROVED		