



www.tritonsystems.co.uk

**Triton Systems**

Units 3 - 5 Crayford Commercial Centre  
Greyhound Way, Crayford, Kent. DA1 4HF

Telephone: **01322 318830**

Fax: **01322 524017**

Email: **info@tritonsystems.co.uk**

Web: **www.tritonsystems.co.uk**

THIS DRAWING IS THE PROPERTY OF TRITON SYSTEMS AND MUST NOT  
BE LOANED OR COPIED WITHOUT PRIOR WRITTEN CONSENT

© 2018 TRITON SYSTEMS

**NOTE**

ALL INSTALLATION TO BE CARRIED OUT IN STRICT ACCORDANCE WITH  
MANUFACTURERS INSTALLATION INSTRUCTIONS. FOR FURTHER  
ASSISTANCE CONTACT **TRITON TECHNICAL** ON THE TELEPHONE  
NUMBER ABOVE.

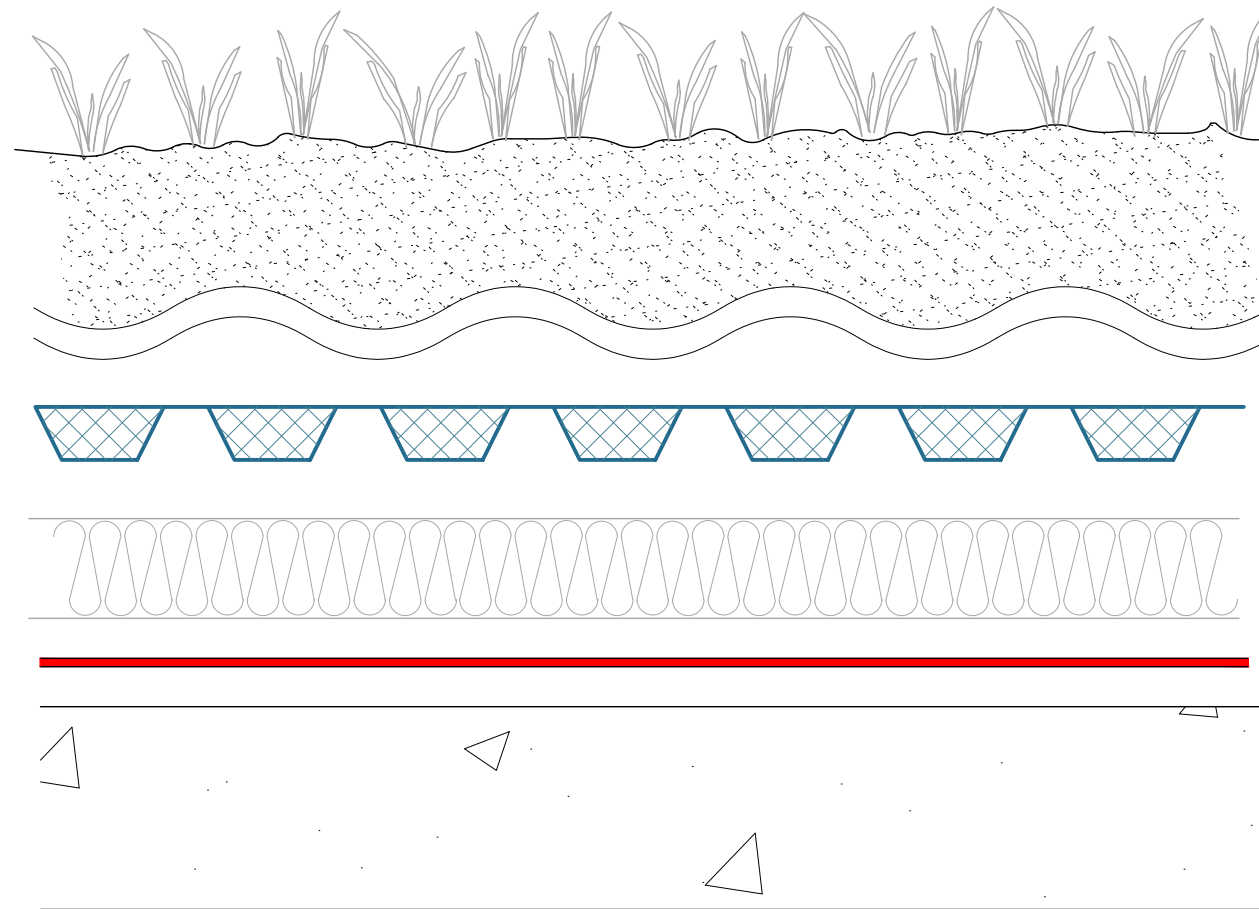

VEGETATION

GROWING MEDIUM

TRITON FILTER FLEECE

DE 25 DRAINAGE & RESERVOIR LAYER

INSULATION - HIGH COMPRESSIVE STRENGTH

TWS - FASTCOAT + GEOTEXTILE ON SUITABLE PRIMER

ROOF DECK / PODIUM / TERRACE

\* SUBSTRATE COULD BE SCREED, CONCRETE, OLD STABLE ASPHALT OR EXTERIOR GRADE PLYWOOD

**FASTCOAT PRIMERS:**

- PU PRIMER FOR NON ABSORBENT SURFACES
- DRY PORUS PRIMER FOR DRY SCREED OR CONCRETE
- 2 PART HUMIDITY PRIMER FOR SCREED OR CONCRETE WITH A RESIDUAL MOISTURE CONTENT

REV.	MOD. BY	DATE	CHK. BY	APP. BY
<b>Alterations</b>				

**TITLE:**  
Typical Retrofit Green Roof  
Build Up Using  
TWS - FASTCOAT + DE25

**DRG. No.** TDECK-001-2 **REV** 3

DRAWN	JDF, CBS, AJ	System Files: TDECK-001-1.pdf TDECK-001-1.dwg
DATE	11th June 2018	
SCALE (A3)	Not To Scale	
CHECKED		
APPROVED		