



Case Study

Triton supplied:

Platon P8 membrane, Platon P20 membrane, Triton TT55ME, 2 x Triton XL sumps with dual configuration Triton 303 pumps, Aqua Channel system, Triton Powersafe alarm unit.

TRITON WATERPROOFS NEW TWO STOREY DOMESTIC BASEMENT

Triton's technical team specified a sealed cavity drain membrane system as well as other waterproofing elements required in the construction of a new, two storey domestic basement. The basement has been designed to accommodate a squash court, gym, swimming pool, multi-media room, cinema, golf driving range, hot water supply and plant room.

All systems were supplied by Triton including Platon P8 membrane to line all exterior walls and deeper studded Platon P20 membrane which was laid to the lower basement floor. Cavity drain membranes work by directing any water entering the wall behind the studded membrane down to a perimeter drainage channel from where it can be drained to a natural or pumped drainage point. This system included a detail to drain water down from the upper to lower basement level via Triton's Aqua Channel drainage conduit fitted to the perimeter of the upper level floor (see detail drawing overleaf). At lower level a similar perimeter conduit drained to a system of 2 x Triton XL sumps in the floor, each fitted with 2 x Triton 303 pumps, offering a 14M maximum vertical output each. Rodding eyes were installed to the drainage conduit at 10M intervals at both levels to allow for periodic maintenance.

A Triton Powersafe automatic (with battery back-up) alarm unit was installed to protect the property in the event of flooding by storing power in case of a mains power loss.

All soffits were treated with Triton's TT55ME, a two component polymer modified cement based, flexible, protective and waterproof membrane coating. Suitable for either vertical or horizontal surfaces TT55ME imparts high adhesion and flexibility along with a high level of water resistance. It is suitable for the internal and external waterproofing of concrete, sound brickwork and cement based elements of water retaining and water resisting structures such as basements, retaining walls, lift pits, swimming pools etc

Triton Anti Lime coating was applied on all new concrete to prevent the leaching of free lime and/or mineral salts from the concrete walls and floors which might create blockages in the cavity drain membrane system.

Main Contractor:

Knight Build Limited, Brentwood, Essex.
www.knightbuild.co.uk



The new concrete frame construction



Platon P8 to walls Platon P20 to floor with Corner Strip to seal wall floor junction



This new text to be supplied



Platon P8 to walls fastened with Brick Plugs and Platon Corner Strip sealing joints following screed to Platon P20 on floor



Block wall being installed over insulation and Platon P8 membrane

Triton Systems

Units 3 – 5 Crayford Commercial Centre, Greyhound Way,
Crayford, Kent DA1 4HF

Tel: 01322 318830

Fax: 01322 524017

Email: info@tritonsystems.co.uk

www.tritonsystems.co.uk

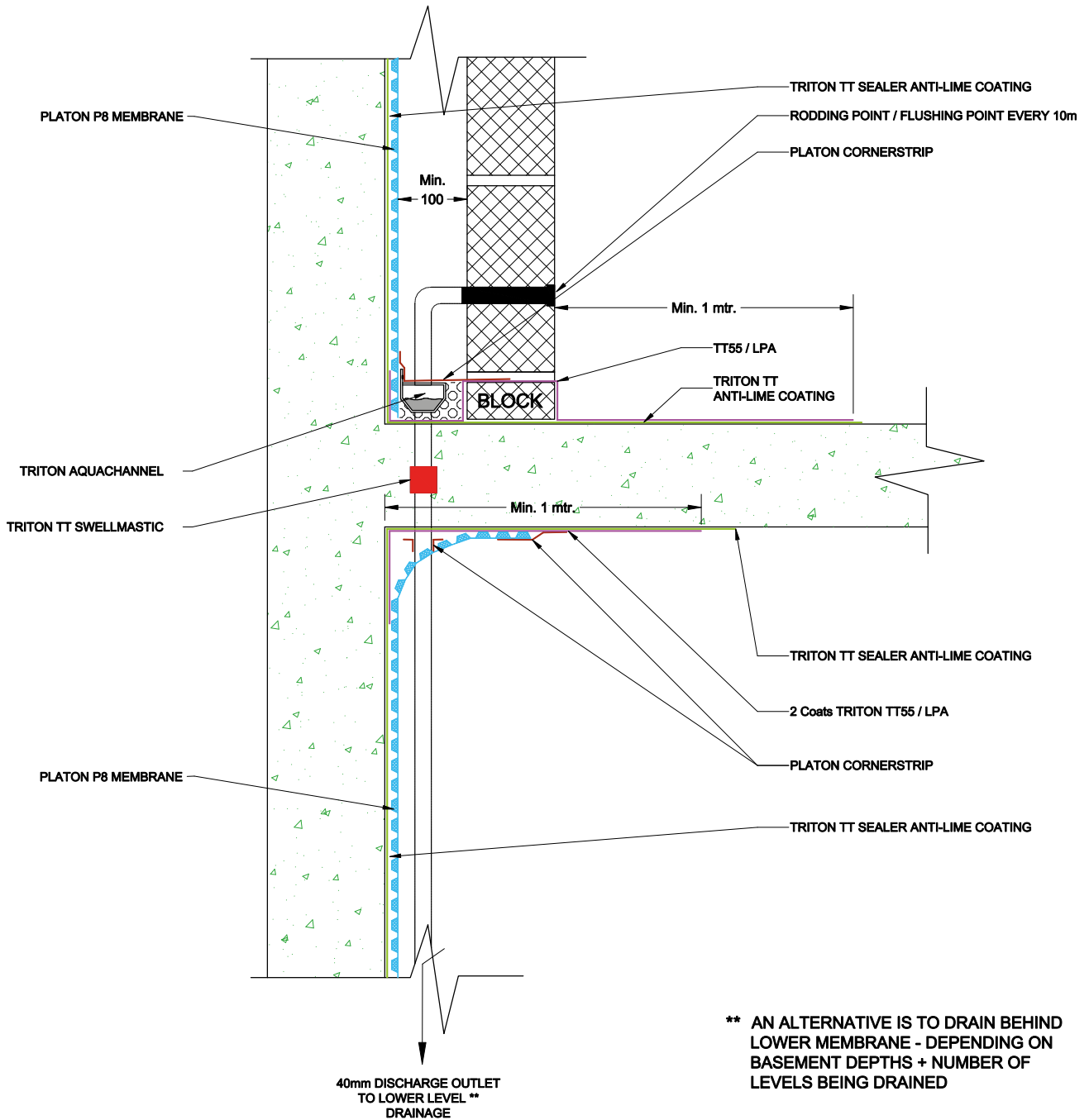

Triton Systems

Units 3 – 5 Crayford Commercial Centre, Greyhound Way,
Crayford, Kent DA1 4HF

Tel: 01322 318830

Fax: 01322 524017

Email: info@tritonsystems.co.uk

www.tritonsystems.co.uk