

TRITON TT VAPOUR
MEMBRANE (2 - 3 COATS)

TRITON TT SUPER 1.5Kg/m²
2 COAT WATERPROOFING

TRITON TT WATERSTOP

TRITON TT WATERSTOP
/ SWELLMASTIC

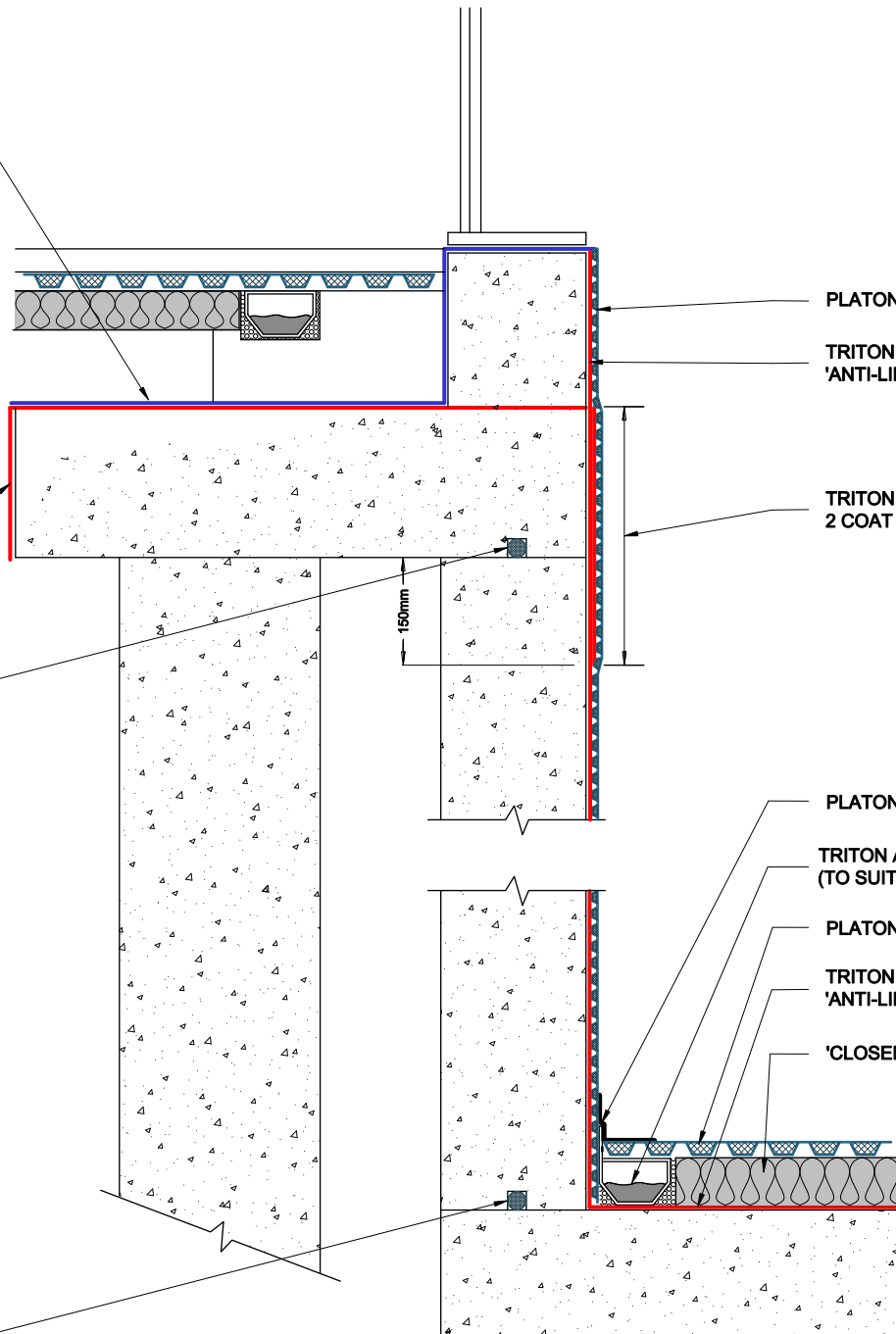

PLATON P8 MEMBRANE

TRITON TT SUPER 0.75Kg/m²
'ANTI-LIME' COATING

TRITON TT SUPER 1.5Kg/m²
2 COAT WATERPROOFING

PLATON CORNERSTRIP

TRITON AQUA CHANNEL & 20mm STONES
(TO SUITABLE DISCHARGE POINT)

PLATON P20 MEMBRANE

TRITON TT SUPER 0.75Kg/m²
'ANTI-LIME' COATING

'CLOSED CELL' INSULATION

TRITON

www.tritonsystems.co.uk

Triton Systems

Units 3 - 5 Crayford Commercial Centre
Greyhound Way, Crayford, Kent. DA1 4HF

Telephone: **01322 318830**

Fax: **01322 524017**

Email: info@tritonsystems.co.uk

Web: www.tritonsystems.co.uk

THIS DRAWING IS THE PROPERTY OF TRITON SYSTEMS AND MUST NOT
BE LOANED OR COPIED WITHOUT PRIOR WRITTEN CONSENT

© 2011 TRITON SYSTEMS

NOTE

ALL INSTALLATION TO BE CARRIED OUT IN STRICT ACCORDANCE WITH
MANUFACTURERS INSTALLATION INSTRUCTIONS. FOR FURTHER
ASSISTANCE CONTACT TRITON TECHNICAL ON THE TELEPHONE
NUMBER ABOVE.

REV.	MOD. BY	DATE	CHK. BY	APP. BY
Alterations				

TITLE:

New Build Concrete Basement
Combined System

DRG. No.	TWS-068-1(D)	REV	2
----------	--------------	-----	---

DRAWN	JDF, CBS, TGL	System Files:
DATE	15th April 2009	
SCALE (A3)	Not To Scale	TWS-068-1(D).pdf
CHECKED		TWS-068-1(D).dwg
APPROVED		